

Colvin Crew Recovery No. 11
September 27, 2003
Goodnow Mountain
Elev. 2,664 '
Adirondack Survey
Signal Sta. No. 83
(D.H.)

Newcomb, N.Y.

a Retro - Recovery - Report
by Jim Schaller



Adirondack Visitors
Center
Newcomb, N. Y.



Goodnow
Mountain



Goodnow Mountain Fire Tower
& Trail Brochure
2003

On September 27th, 2003 , thirteen Colvin Crew members
and guests - met at the
Adirondack Visitors Center in Newcomb, N. Y.

Supt. Kerm Remele presided over our meeting. Then we drove west – to the Goodnow Mountain trailhead . A group photo of the Crew was taken at the Kiosk at the trailhead. We then followed the much improved trail up to the summit . The Fire Tower was also restored. Colvin's Bolt is now just a stub at the base of it's drill hole. The U.S.G.S. bolt was also missing. Only one intact eye - bolt remained. The U.S.C.& G.S. disc "GOODNOW " was recovered.

(Unfortunately, Supt. Kerm Remele & Mary Ann weren't able to make the climb up Goodnow Mtn.)

Colvin Crew Recovery No. 11 - Goodnow Mountain
13 attended - including 7 Crew Members ,
and 6 guests - as follows:

Supt. Kerm Remele
Jim Schaller
Bob Schurman
C. Donald Carpenter
Ralph Schliessler
Rob Harris
Larry Rathman

Guests:
Mary Ann Remele
Bonnie Schaller
Jody Schliessler
Rob Harris's son
Beth Rathman
Justin Rathman

Goodnow Mountain
Trail
off Rt. 28N
Newcomb, N. Y.



Colvin Crew Recovery No. 11 GOODNOW MOUNTAIN
Signal Station No. 83 Sept. 27, 2003

COLVIN CREW MEETING

September 27, 2003

At 9 a.m. we gathered in the Adirondack Visitors Center in Newcomb, New York.

Present were Crew Guide Jim Schaller & Bonnie, Supt. Kerm Remele & Mary Ann, Bob Schurman, Don Carpenter, Ralph & Jody Schissler, Rob Harris & son, Larry & Beth Rathman & son Justin. And a special note; Rob Harris came all the way from Colborne, Ontario (near Toronto). Our first Colvin Crew Canadian!

Supt. Kerm opened the usual informal meeting with explanation of his recent inactivity; diagnosis & treatment of bone cancer, which kind providence has sent into remission & has allowed him to return to a quiet, happy life with Mary Ann on Cranberry Lake. But he noted that the Crew should be prepared to change leadership.

Colvin Crew Report for Meeting in Newcomb, N.Y. Sept. 27, 2003 (by Supt. Kerm Remele)

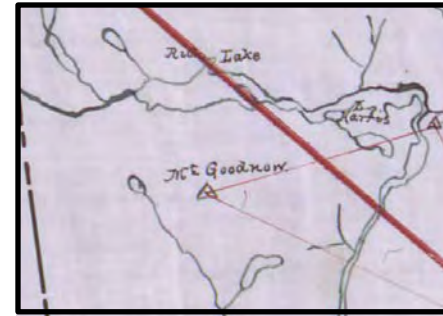

Verplanck Colvin's Triangulation Map showing Mt. Goodnow

Colvin Crew Report for Goodnow Mtn. (by Jim Schaller)



The Colvin Crew gathers at the kiosk by the Trailhead up Goodnow Mountain (Lt. to Rt. :) Rob Harris & son, Justin Rathman, Bob Schurman, Larry Rathman, Supt. Kerm Remele & Mary Ann, Ralph & Jody Schissler, Don Carpenter, and Jim Schaller (Guide). (Photo by Bonnie Schaller)

COLVIN CREW REPORT
 SEPT.27, 2003
 GOODNOW MOUNTAIN
 NEWCOMB, N.Y.

The Crew met at the Adirondack Visitor Information Center in Newcomb, N.Y. on a beautiful early Autumn day. The meeting, presided over by Supt. Kerm Remele, discussed the Crew's past; proposed projects; and plans for future "Followings". 14 Crew members and guests participated.

Then we drove to the Goodnow Mountain trailhead. We found the trail much improved, with rock work; benches; boardwalks; and steps. On the summit (2685') the Fire Tower has been restored - with new windows, steps, and a circular topo map table (like the original) in the cab. Historical notes were in the cab and at the adjacent observer's cabin. Despite a gusty South wind, several climbed up the tower to see the extensive views and early fall colors. A friendly group of ADK hikers shared the summit with us.

Colvin's bolt (number unknown) is just a stub in a counter-sunk drill hole. One eye-bolt remains. USCGS "GOODNOW-1942" was found, and an additional drill hole- possibly the location of an early 1940's USGS plug. Colvin's original 3 transit leg drillholes were identified.

On a quicker descent, we passed many more hikers who were ascending this popular Fire Tower peak!

**(We since found out that the Survey Bolt on Goodnow Mt. was No. 83)
 -JS**



the Colvin Crew on Goodnow Mountain



↑ Views from the
Goodnow Mountain
Fire Tower
over Rich Lake
to the High Peaks -
September 27, 2003 ↗

the Colvin Crew
by the Goodnow Mountain
Fire Tower



Goodnow Mountain from
Mt. Van de Whacker
(N.Y.S. Archives)



The restored
Fire Tower Observer's Cabin
on Goodnow Mountain's
summit.
2003



c. 1900 U.S.C. & G.S. Topo Map showing the Colvin Bolt No. 83 on Goodnow Mountain – just south of Rich Lake



c. 1970's U.S.C. & G.S. topo map – showing the trail up Goodnow Mtn., the "Lookout Tower", and U.S.C. & G.S. Sta. "GOODNOW" 1942



U.S.C. & G.S. Station Disc "GOODNOW" 1943

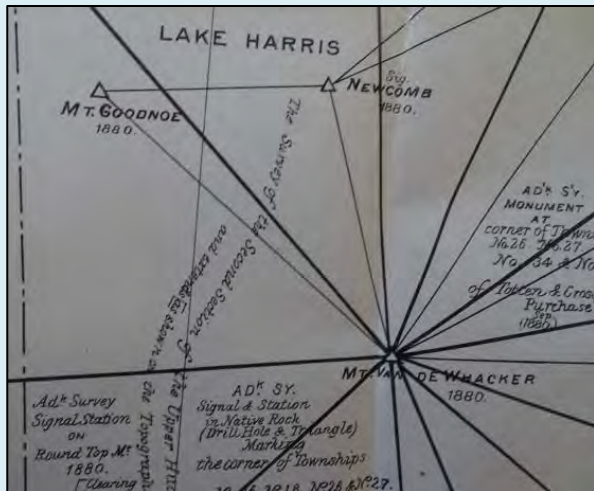

On this 1880 Triangulation Map of Colvin "Mt. Goodnoe" (Signal Sta. No. 83) is shown – tying into the stations on Mt. Van De Whacker (Sta. 55), and "Signal Newcomb".



Drill Holes of the Adirondack Survey's Station Bolt No. 83 (top left), and the U.S.G.S. "Plug" Bolt (D.H. - lower right)

September 27, 2003

Colvin Crew Recovery No. 11,
 Sept. 27, 2003
 Goodnow Mountain
 Newcomb, N.Y.

Retro – Report
Respectfully Submitted
Jim Schaller, 2019